



Merle Norman www.newnancosmetics.com
 272 Bullsboro Dr #A
 Newnan, GA 30263
 770.683.6375

RIBBON TYING INSTRUCTIONS

For Caroline, Madison and Mule Styles



1 Cut a ribbon of your choice at a 21" length and thread through the grommets.



2 Left end (A) needs to be longer. Match the tip of short end (B) to the lower corner of the longer end (A).

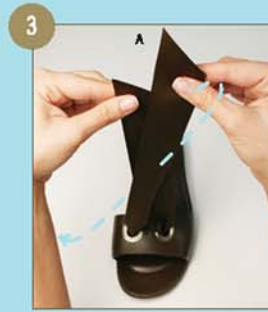

3 Cross the longer end (A) OVER the shorter ribbon (B). Loop the longer end (A) over the top and under the short end (B).



4 Pull each end of the ribbon away from one another to tie a knot.



5 Fold the shorter end (B) in half to form a loop. Secure the loop in place with your thumb.



6 While holding the loop (B) in place with your thumb, bring the longer end of the ribbon (A) over and around the loop (B).



7 Wrap the longer end (A) over and around the loop (B). Push the surface of ribbon (A) with your index finger under and through the knot.



8 Hold loop (B) with your thumb while pushing the ribbon (A) under the knot.



9 Tighten the knot by pulling on the bows.